



# Eolos Compact

Thin Wall Drip Line

Maximize Your Farm with Longer Run Lengths



# Maximize Your Farming

## Have you ever wondered why some drip lines can work for longer run lengths than others?

The maximum distance a drip line can function is dependent on a number of factors including the exponent (correlation between flow output and pressure) and the  $kd$  value (friction caused by each emitter in the drip line). The lower the exponent and the  $kd$  value, the further you can run your drip irrigation system while still maintaining a high standard of irrigation uniformity.

Eolos Compact's design minimizes friction loss through its small design, and its uniquely engineered flow path that minimizes the exponent. In other words, Eolos Compact allows you to achieve longer distances per row while still maintaining high uniformity.

## Unique emitter design for high uniformity over longer distances



Water Flow



## Maximum: Run Length Comparison

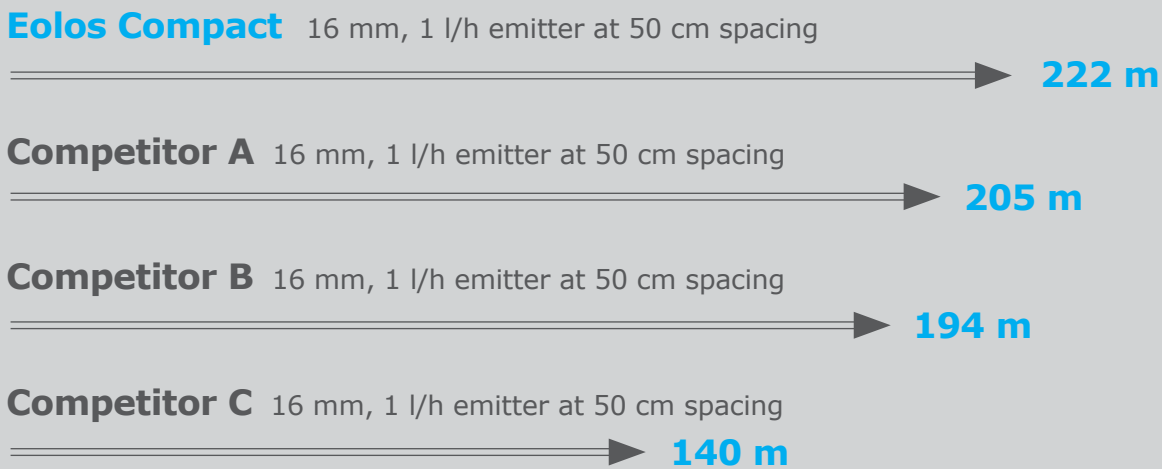

Calculations based on 1 bar pressure, flat ground and 10% maximum flow variation.

## Maximize: Potential Benefits For Your Farm

- Achieve longer run lengths with a smaller diameter tube – Save on installation costs
- Irrigate longer rows for more efficient farming operations – Longer rows, fewer tractor turns
- Greater uniformity of irrigation over longer run lengths – More consistent crop yields

# Designed To Perform

**70% Smaller than competitive drippers** - Not only does a small emitter help reduce water friction in the drip line, a smaller emitter is easier to install with less risk of being caught on installation equipment.

**Large cross section labyrinth** - With up to a 54% larger labyrinth than leading competitor products, the large labyrinth in every emitter helps Eolos Compact perform when other products clog.

**Trusted Worldwide** - From South America, to USA, to Europe, growers around the world trust Eolos Compact. Did you know, the amount of Eolos Compact sold each year would wrap around the world 42 times?

**Higher Maximum Operating Pressure** - Eolos Compact's durable construction allows for up to 20% higher published maximum operating pressure compared to competitive products.

**Printed White Stripes On Tube** - For easy emitter identification Eolos Compact features optional two white stripes to identify direction for correct installation.

**Flap Outlet Option** - Eolos Compact has a flat outlet option that helps prevent soil ingestion during system shut-down - a great advantage for buried applications.

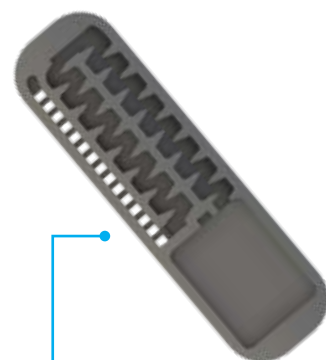

## Eolos Compact Technical Data

Nominal Ø	Wall Thickness		Internal Ø	Outside Ø	Nominal Flow Rate at 1.0 bar Pressure	Maximum Operating Pressure	Roll Length (according to emitter spacing)	Maximum Run Length (10% FV on Flat Ground) Spacing Between Emitters (cm)								
	(mil)	(mm)						15	20	25	30	33	40	50	60	75
(mm)			(mm)	(mm)	(l/h)	(bar)	(m)	(m)	(m)	(m)	(m)	(m)	(m)	(m)	(m)	(m)
12	6	0.15	11.7	12	0.65	1.5	3400 (20 cm)	69	85	99	112	120	137	159	179	209
					1.0		3500 (25 cm)	52	64	75	85	91	103	120	136	158
					1.4		3600 (≥30 cm)	42	52	60	68	73	83	97	109	127
					2.27			31	38	44	50	53	61	71	80	92
	8	0.2	11.6	12	0.65	1.7	3300 (20 cm)	69	84	98	111	119	136	158	178	206
					1.0		3400 (25 cm)	52	64	74	84	90	102	119	134	156
					1.4		3500 (≥30 cm)	42	51	60	67	72	82	96	108	125
					2.2			31	38	45	50	54	61	68	75	82
16	5	0.135	16.37	16.37	0.65	0.8	3100 (10 cm)	121	147	171	194	234	272	306	355	368
					1.0		3200 (15 cm)	93	114	132	149	159	181	210	236	274
					1.4		3300 (20 cm)	77	93	107	121	129	146	169	190	220
					2.27		3500 (25 cm)	58	70	81	91	97	110	128	143	166
	6	0.15	16.4	16.4	0.65	1.0	2600 (10 cm)	122	148	172	195	236	274	308	357	370
					1.0		2700 (15 cm)	95	115	134	151	161	183	212	239	277
					1.4		2800 (20 cm)	77	94	109	122	130	148	171	192	223
					2.27		2900 (25 cm)	59	71	82	92	99	112	130	146	169
	8	0.2	16.1	16.5	0.65	1.2	2500 (10 cm)	123	149	173	196	237	275	310	359	376
					1.0		2600 (15 cm)	99	120	140	158	168	191	222	250	290
					1.4		2700 (20 cm)	78	94	110	123	131	149	173	194	224
					2.2		2800 (25 cm)	59	72	83	94	100	113	131	148	170
	10	0.25	16.6	16.6	0.65	1.4	2100 (10 cm)	123	150	174	197	238	276	311	361	368
					1.0		2200 (15 cm)	100	122	142	160	171	194	225	254	294
					1.4		2300 (20 cm)	80	97	112	126	134	152	176	199	230
					2.2		2400 (25 cm)	60	72	84	94	101	114	132	149	173
	12	0.3	16.7	16.7	0.65	1.5	1600 (10 cm)	125	152	176	199	241	279	315	361	369
					1.0		1700 (15 cm)	101	123	143	161	172	195	226	255	296
					1.4		1800 (20 cm)	80	97	112	126	135	153	177	199	230
					2.2		1900 (25 cm)	60	73	84	95	101	115	133	149	173
22	8	0.2	22.2	22.6	0.65	1.0	1900 (15 cm)	208	254	296	335	406	471	532	616	649
					1.0		2000 (20 cm)	166	202	236	266	284	323	375	424	491
					1.4		2100 (25 cm)	133	161	187	211	224	255	295	332	384
					2.2		2100 (≥30 cm)	101	122	142	160	170	193	224	252	291

# Eolos Compact Technical Data (Cont.)

Nominal Ø	Wall Thickness		Internal Ø	Outside Ø	Nom. Flow Rate at 1.0 bar Pressure	Maximum Operating Pressure	Roll Length (according to emitter spacing)	Maximum Run Length (10% FV on Flat Ground) Spacing Between Emitters (cm)								
	(mil)	(mm)						15	20	25	30	33	40	50	60	75
(mm)	(mm)	(mm)	(mm)	(mm)	(l/h)	(bar)	(m)	(m)	(m)	(m)	(m)	(m)	(m)	(m)	(m)	(m)
22	10	0.25	22.2	22.7	0.65	1.3	1300 (15 cm)	210	256	298	337	409	475	536	621	654
					1.0		1400 (20 cm)	174	212	247	280	298	339	394	445	515
					1.4		1500 (25 cm)	135	163	189	214	227	258	299	337	389
					2.2		1600 (≥30 cm)	103	124	144	163	173	196	228	256	296

## Flow Rate (l/h) vs. Pressure (bar)

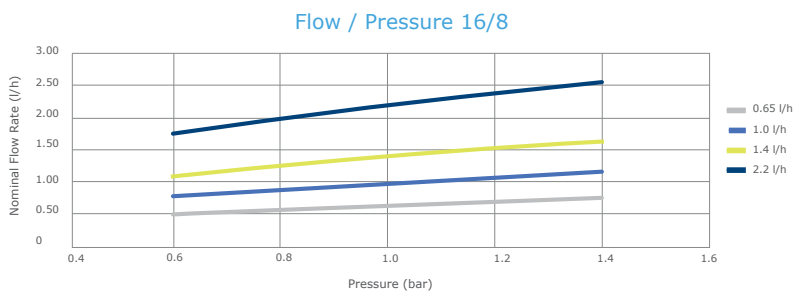
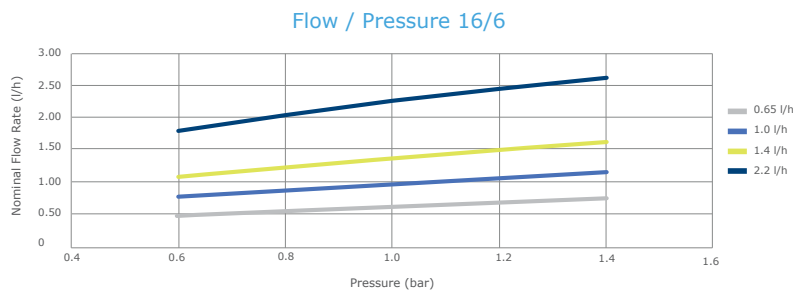

## Maximize: Connectors

When it comes to drip line connectors there are two things that matter most – ease of installation and reliability. Rivulis Fast Ring Drip Line Connectors live up to their name – FAST! In-field they are quick to install with a large, easy-to-tighten nut that fixes effortlessly to your drip line.

Once they are installed, you can have the confidence that they will perform. Each Fast Ring Connector is designed for maximum adhesion. In addition, high quality UV resistant construction ensures that your connector will last season after season.



“By achieving longer run lengths using Eolos Compact, we significantly reduced our labor costs for installation in our corn crop”.

**Veyssel Dursun, Manisa / Selimşahlr, Turkey**



This literature has been compiled for worldwide circulation and the descriptions, photos, and information are for general purpose use only. Please consult with an irrigation specialist and technical specifications for proper use of products. Because some products are not available in all regions, please contact your local dealer for details. Every effort has been used to ensure that product information, including data sheets, schematics, manuals and brochures are correct. Eurodrip reserves the right to change specifications and the design of all products without notice.